

# PHOR 4 WIFI BOOSTER Mobile Phone Setup

## 1 Plug in your WiFi Booster and wait for 30 seconds

The lights for 'Power' and 'WiFi' should both turn on

**\*Troubleshooting**  
To factory reset the device, use the include pin tool to press and hold the pin hole for 5 sec to reset.



## 2 Connect to the Booster SSID

Connect to the SSID of 'wifi-xxxx'  
'xxxx' are the last four digits of the MAC address found on the back of your WiFi Booster

**\*NOTE**  
You cannot access the internet until all of the steps have been completed

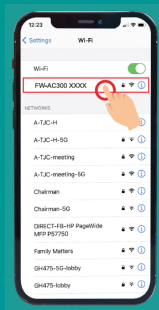

## 3 Open your browser webpage

Chrome / Safari / Firefox recommended, enter **192.168.188.1** into your search bar

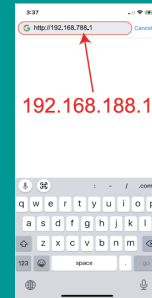

## 4 Log in with the default password: admin

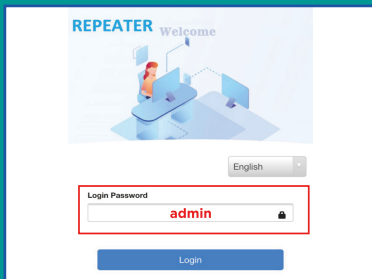

## 5 Select your host router SSID

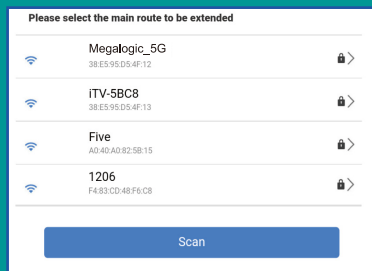

## 6 Enter the password for your host router

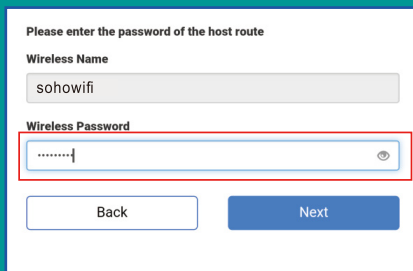

## 7 Set your Booster SSID and password

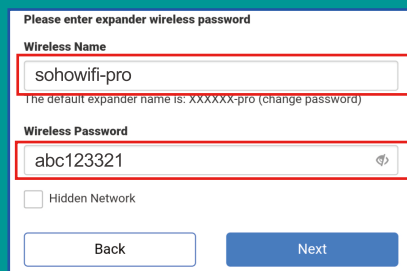

## 8 Confirm the wireless info

Check your information details and click 'Start Connect'

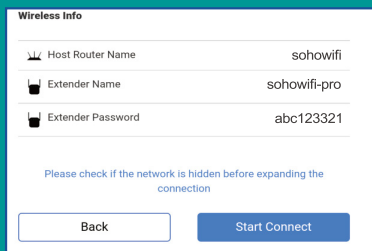

## 9 Wait for the Booster to connect to the router

After the setup is completed, check the 'Extender' status light on the front of your device. If it is lit up, your relay was successful and you can now connect your Booster to the internet. Otherwise, please try reconnecting.

## What's Included

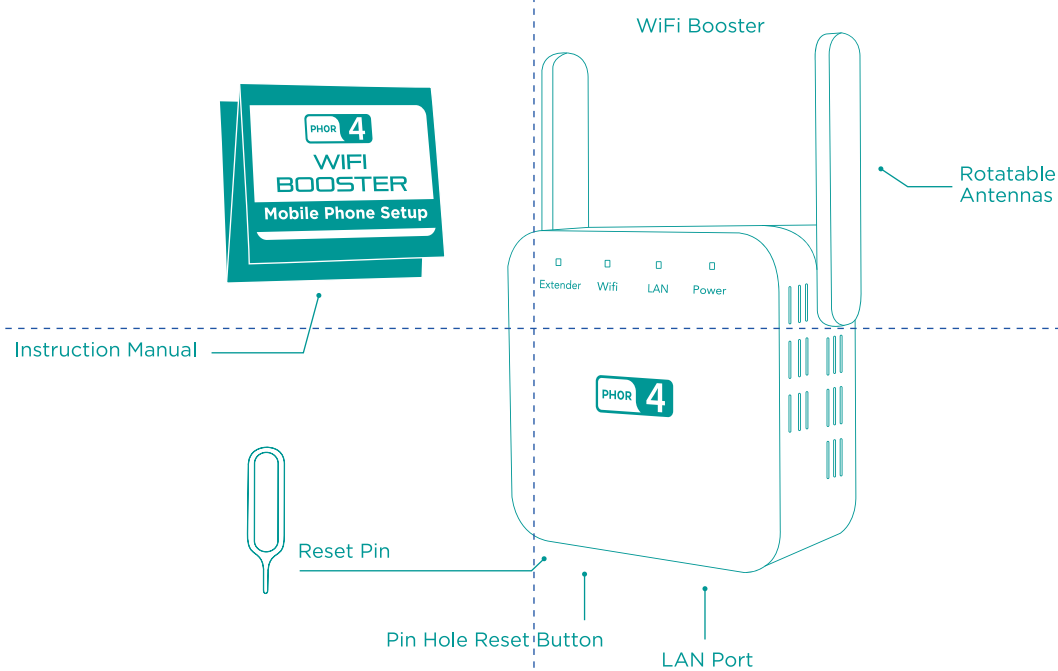

## 10 The 'Extender' light will turn on if completed successfully



## 11 Reconnect to your Booster WiFi

Reconnect to your Booster SSID for internet access



# PHOR 4 WIFI BOOSTER PC / MAC Setup

## 1 Plug in your WiFi Booster and wait for 30 seconds

The lights for 'Power' and 'WiFi' should both turn on

**\*Troubleshooting**  
To factory reset the device, use the include pin tool to press and hold the pin hole for 5 sec to reset.



## 2 Connect to the Booster SSID

Connect to the SSID of 'wifi-xxxx', 'xxxx' are the last four digits of the MAC address found on the back of your WiFi Booster

**\*NOTE**  
You cannot access the internet until all of the steps have been completed

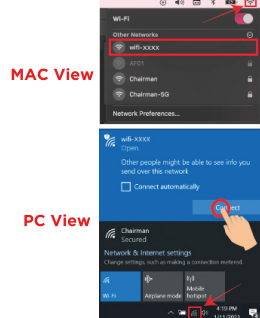

## 3 Open your browser webpage

Chrome / Safari / Firefox recommended, enter **192.168.188.1** into your search bar

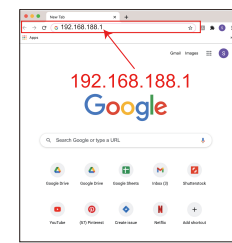

## 4 Log in with the default password: admin

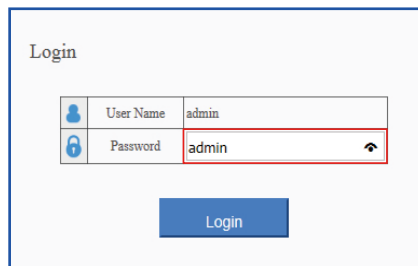

## 5 Select your host router SSID

Multiple channels working together could negatively interfere with your signal and network speed. If you notice this, you can change the main router channel.

Wireless Name	MAC	Channel	Auth Mode	Signal
MEGALOGIC_5G	38:E3:91:D6:4F:12	1	WPA2-Personal	Full
ITV-SBC8	38:E3:91:D6:4F:12	1	WPA2-Personal	Full
Five	38:E3:91:D6:4F:13	1	WPA2-Personal	Full
sohowifi	38:E3:91:D7:03:41	1	WPA2-Personal	Full
CISG	38:E3:91:D1:00:40	1	WPA2-Personal	Full

## 6 Enter the password for your host router



## 7 Set your Booster SSID and password

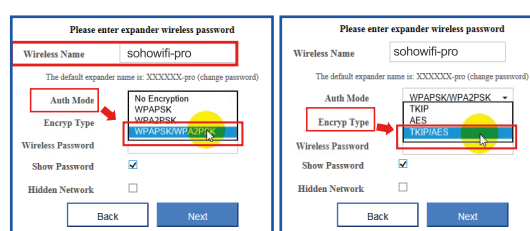

## 8 Confirm the Wireless Info

Check your information details and click 'Start Connect'



## 9 Wait for the Booster to connect to the router

After the setup is completed, check the 'Extender' status light on the front of your device. If it is lit up, your relay was successful and you can now connect your Booster to the internet. Otherwise, please try reconnecting.

## Customer Service

<https://support.getphor4.com/>



## FCC Compliance Statement

This device complies with part 15 of the FCC rules. Operation is subject to the following two conditions: (1) this device may not cause harmful interference, and (2) this device must accept any interference received, including interference that may cause undesired operation.

Changes or modifications not expressly approved by the party responsible for compliance could void the user's authority to operate the equipment.

**NOTE:** This equipment has been tested and found to comply with the limits for a Class B digital device, pursuant to part 15 of the FCC Rules. These limits are designed to provide reasonable protection against harmful interference in a residential installation. This equipment generates uses and can radiate radio frequency energy and, if not installed and used in accordance with the instructions, may cause harmful interference to radio communications. However, there is no guarantee that interference will not occur in a particular installation. If this equipment does cause harmful interference to radio or television reception, which can be determined by turning the equipment off and on, the user is encouraged to try to correct the interference by one or more of the following measures:

- Reorient or relocate the receiving antenna.
- Increase the separation between the equipment and receiver.
- Connect the equipment into an outlet on a circuit different from that to which the receiver is connected.
- Consult the dealer or an experienced radio/TV technician for help.

## Radiation Exposure Statement

This equipment complies with FCC radiation exposure limits set forth for an uncontrolled environment. This equipment should be installed and operated with minimum distance 20cm between the radiator and your body.

FCC ID: ZNPWD-R611U

